

Sezione orizzontale versione ad un battente

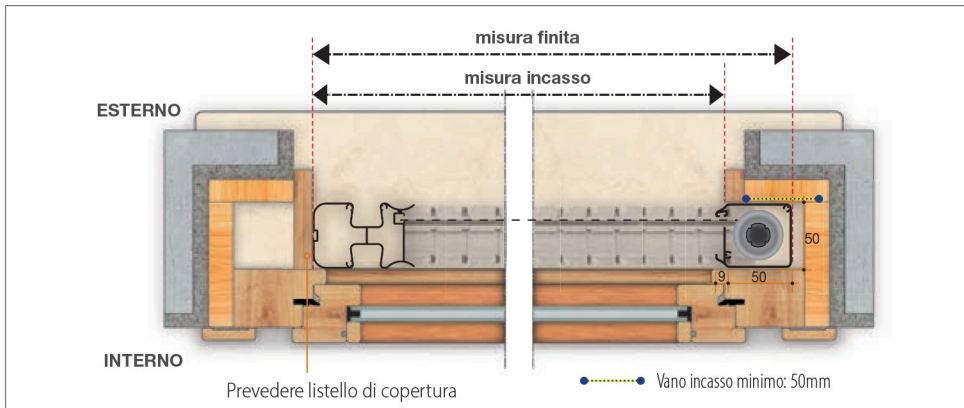

Sezione orizzontale versione a due battenti

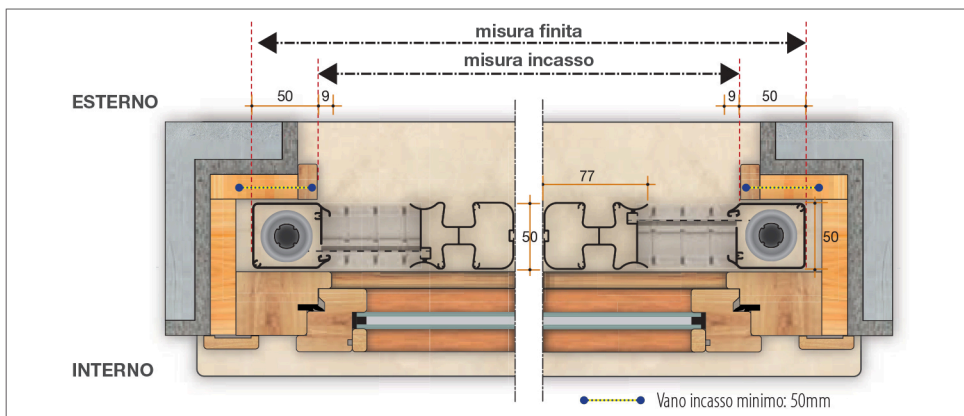

Sezione verticale

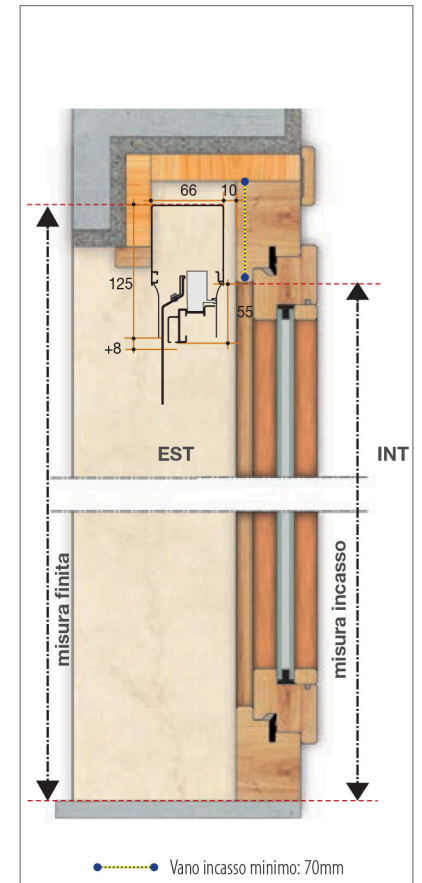

Ingombro Cassonetto e Barra maniglia.

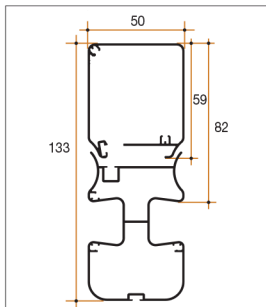

Optional

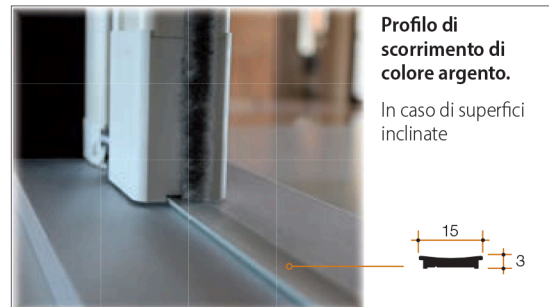

Optional

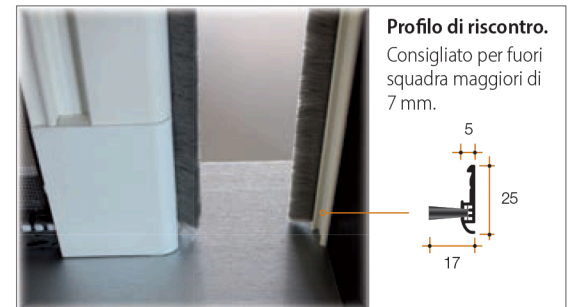

Carter Motore e guida

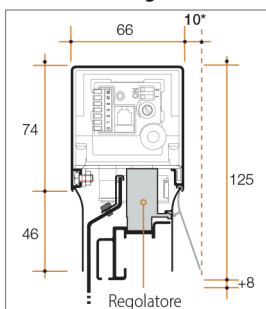

***Carter Motore ispezionabile:**
per consentire l'apertura della aletta di ispezione prevedere una distanza minima tra carter e serramento di 10mm.

Regolazione automatica del fine corsa



Protezione automatica contro ostacoli

